

ELECTRICAL CONNECTION

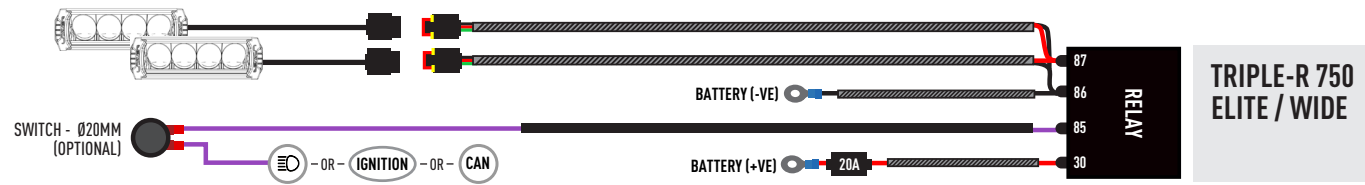

LAMP CONNECTOR INFORMATION

TRIPLE-R POSITION LIGHT FUNCTION (OPTIONAL)

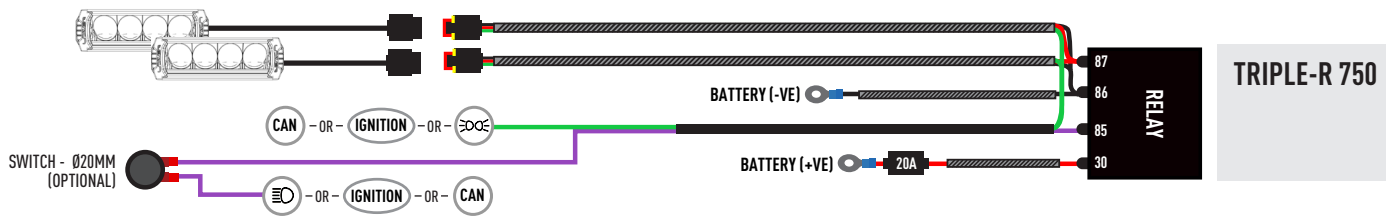
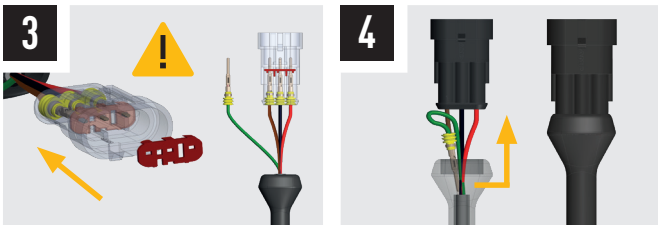
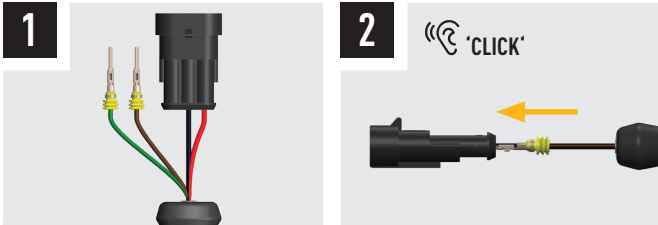

CANBUS INTEGRATION (SOLD SEPERATELY)

For vehicles where it is not possible to locate a 12V high beam signal, it will be necessary to take the high beam signal from the vehicle's CAN system. For connection options please visit the Lazer Lamps website, or contact your nearest dealer.

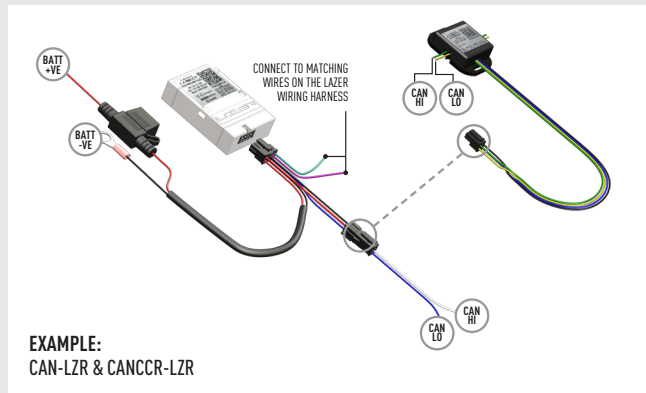

E9 UNECE REGULATIONS

Please scan the QR code to view all UNECE Certificates and information.



LAZER

HIGH PERFORMANCE LIGHTING

MERCEDES VITO (2024+) TRIPLE-R 750 GRILLE KIT

FITTING INSTRUCTIONS



LAZER

HIGH PERFORMANCE LIGHTING

WWW.LAZERLAMPS.COM

We appreciate your purchase of a Lazer Lamps product, and value your feedback. If you would like to leave feedback on your Lazer experience, please head to the relevant product page on our website www.lazerlamps.com.

T +44 (0) 1992 677374
E sales@lazerlamps.com

Lazer Lamps Ltd, Calder House, Central Road
Harlow, Essex, CM20 2ST, UK

MADE IN THE UK /LAZERLAMPS

WHAT'S INCLUDED

4x Grille Mounting Brackets
 4x Cutter Guides
 Anti-Theft Fasteners & Key Fitting Instructions

Additionally - Kit Includes:

2x Triple-R 750 LED Lights
 1x Two-Lamp Wiring Kit

TOOLS REQUIRED

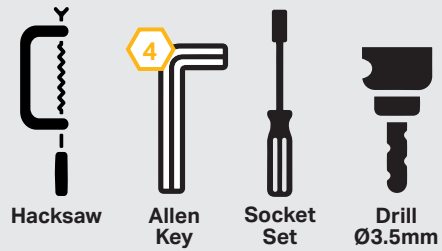

TORQUE VALUES

The code is written on the inside of each bracket (see example).

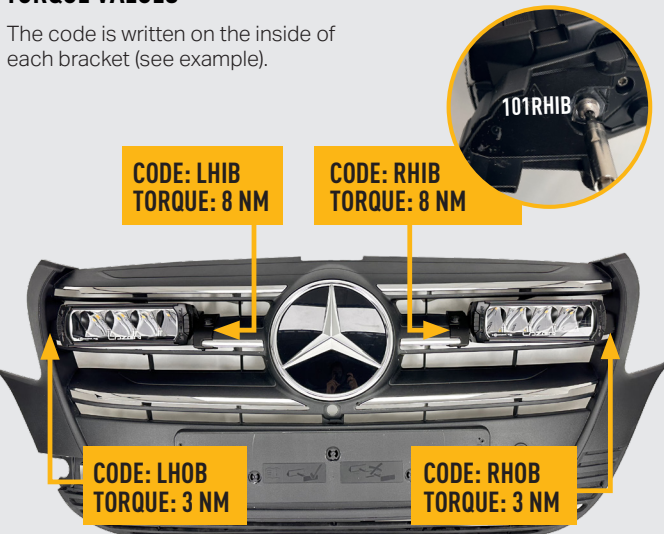

INSTALLATION PROCESS - Grille will need to be removed from the vehicle (please see vehicle manufacturer's guide) for steps 1 & 2.

1

90MM
170MM

Cut the Air guides that are located behind the grille as per the measurements shown to allow clearance for the lamp.

Complete step on both sides.

2

200MM

The side air guide will also need to be cut to allow clearance for the lamps. Follow the measurements shown (measure from the bottom of the headlamp).

Complete step on both sides.

Re-attach the grille. Next steps to be complete with grille on the vehicle.

3

1 2 3 4

4

5

6

Torque info see adjacent.

Please use a thread seal compound (i.e. Loctite 222) to protect the lamp fastener from binding over time.

7

8

9

Ø3.5mm

10

x4

11