



INSTALLATION INSTRUCTIONS (K420)
SPORTLID FOR TANGO
 Toyota Hilux D/C, 2015+

A X1		B X1		C X2		D X2 Locator	
E X2 M8 Slide Bolt		F X4 M8 Wing Nut		G X1 Latch Pin		H X12 M6 Button Hex with washers	
I X2 415mm 300Nm	J X4 M10x40mm Button Hex	K X4 M10x25mm Washer	L X4 M10 Retainer Washer	M X1 Latching Relay	N X1 Toyota Vehicle Loom	O X3 Cable Tie 100mm	
P X1 Blade Fuse Adaptor	Q X1 Fuse 5	R X1 Fuse 10	S X4 M5x25mm Button Hex	T X6 M5x16mm Button Hex	U X10 M5x1.6mm Nylon washer	V X10 30x30mm channel Seal	W X10 10mm OD Spacer
X X4 M5 Dome Nut	Y X2 60x15mm Foam Blocks	Z X2 Top C-Channels		AA X1 Sportlid Badge	BB X4 Cable Tie 450mm	CC X4 Foam weather seal	DD X4 M10 Nylon Spacer
 TANGO		<p align="center">SPORTLID FOR TANGO can be fitted with the Proform SPORTBAR.</p> <p align="center">See steps 26 to 31 for fitting instructions.</p>				<p align="center">SPORTLID FOR TANGO can be fitted with the Toyota OE Sportbar.</p> <p align="center">See steps 32 to 36 for fitting instructions.</p>	

Fitting Kit Number	Manufacturer	Model Type	Year	Stockist	Cab Size	Product	Revision	Date	Page
K420	Toyota	Hilux	2015	General Use	DC	SLT	1	18/12/15	1 of 11

- Fitting your **SPORTLID** for **TANGO** ensure Vehicle Loom is fitted first.
- IF a **BEDLINER** or **SPORTGUARD** is Prefitted please remove Tailgate only before fitment begins.
- When Refitting **BEDLINER** or **SPORTGUARD** Tailgate refer to **TANGO** fitting kit K421 before refitment as additional trimming is required.

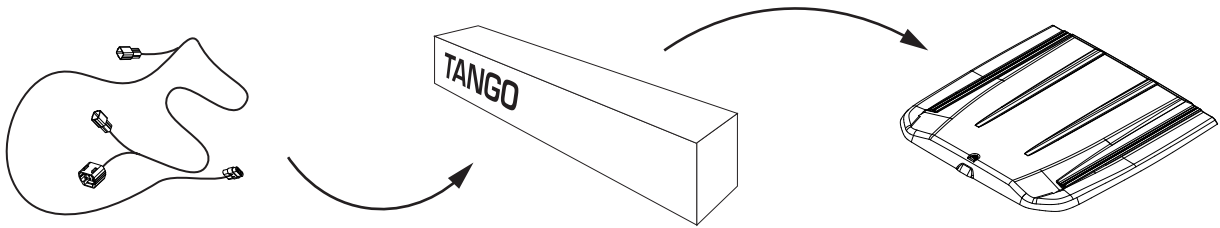

1

Go to the RH side (driver's) of the vehicle. Open the front driver's door and remove the lower plastic scuff plate by prising upwards.



2

Go to the RH side (driver's) of the vehicle. Open the front driver's door and remove the kick panel by removing plastic nut and prising upwards



Drivers seat
Reach under the carpet of drivers seat and remove rubber grommet positioned above the chassis

Chassis



Discard grommet

3



4

Guide the illustrated end of vehicle loom under the carpet and through the hole that the grommet was removed from in step 3



Draw the loom through the hole until the large grommet pops into position

5

Fitting Kit Number	Manufacturer	Model Type	Year	Stockist	Cab Size	Product	Revision	Date	Page
K420	Toyota	Hilux	2015	General Use	DC	SLT	1	18/12/15	2 of 11

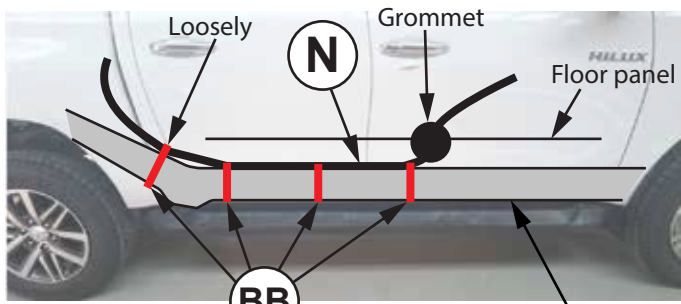

Cable tie the loom to top-side of vehicle chassis as illustrated above. Note cable tie where chassis tapers. Do not fully tighten

6

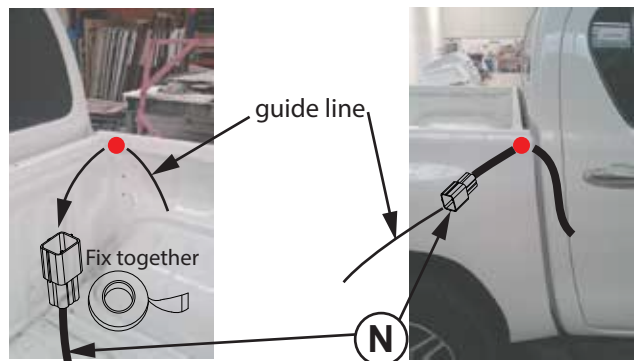

Use a length of flexible cord to pull the loom through a hole in the front right of tub underneath the side rail

7

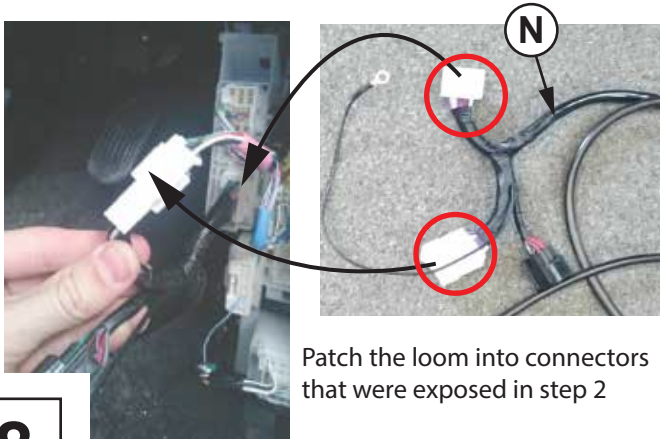

Patch the loom into connectors that were exposed in step 2

8

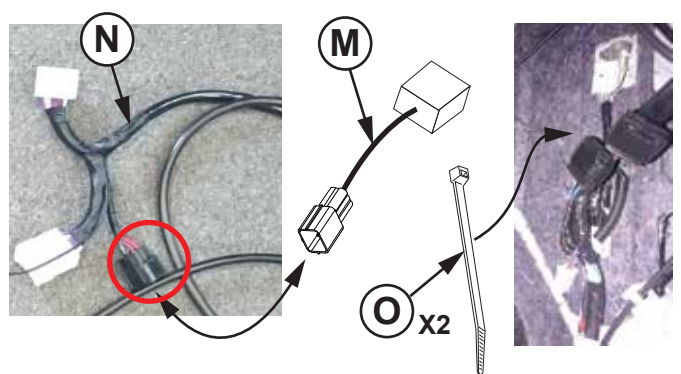

Connect the patching relay to black connector. Cable tie the patching relay out of the way high in kick panel area

9

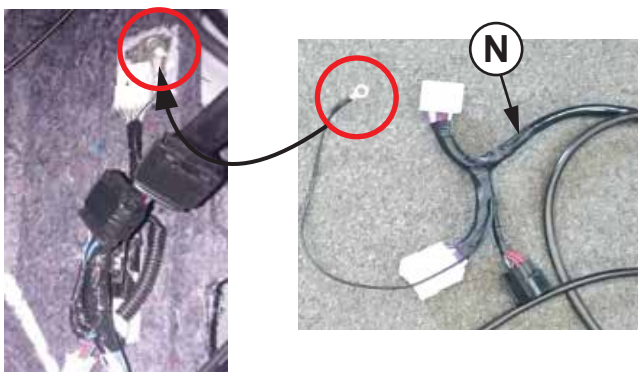

Connect earth wire to bolt pictured high in the kick panel

10

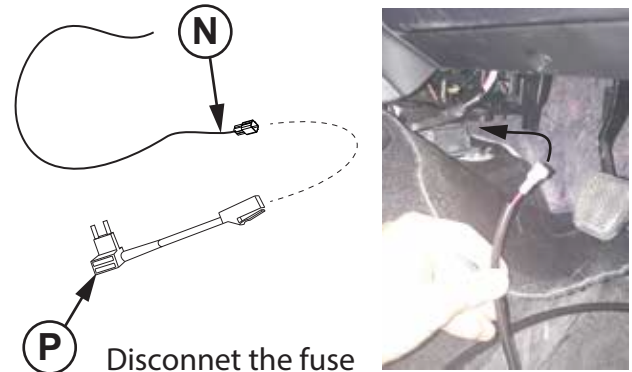

Disconnect the fuse adaptor and thread the remaining loom length under the carpet and through to opposite footwell

11

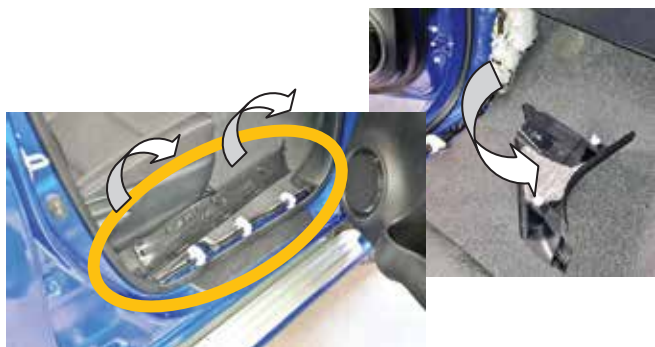

Remove passenger side scuff plate and kick panel similar to steps 1 & 2. Peel back carpet.

11

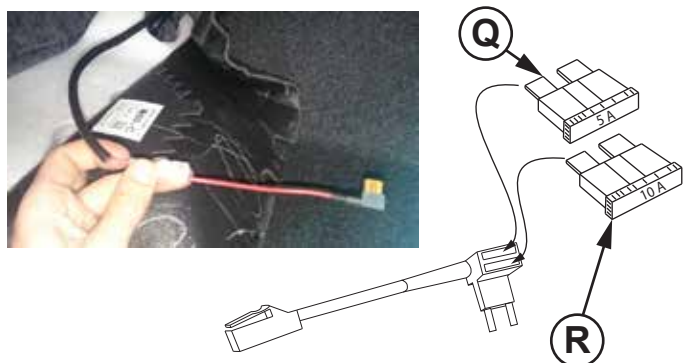

Retrieve the loom passed through in step 11 and connect the fuses as illustrated

12

Fitting Kit Number	Manufacturer	Model Type	Year	Stockist	Cab Size	Product	Revision	Date	Page
K420	Toyota	Hilux	2015	General Use	DC	SLT	1	18/12/15	3 of 11



Remove the lower 10 AMP fuse from vehicle fuse box and discard

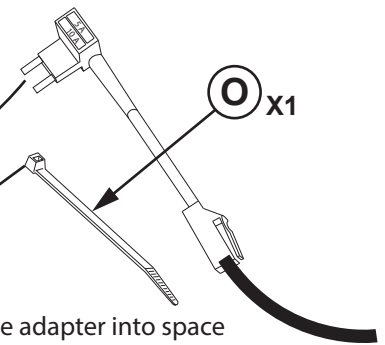
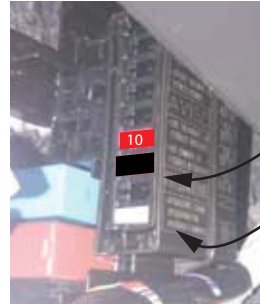

Connect the fuse adapter into space left by discarded 10A fuse. Use remaining small cable tie to secure fuse adapter out of the way.

13

14

Replace all carpet ensuring that loom cables are safely secured and free from sharp edges. Replace both kick panels & scuff plates to original positions.

Loom fitment now complete

15

Fit Toyota Hilux **TANGO**.

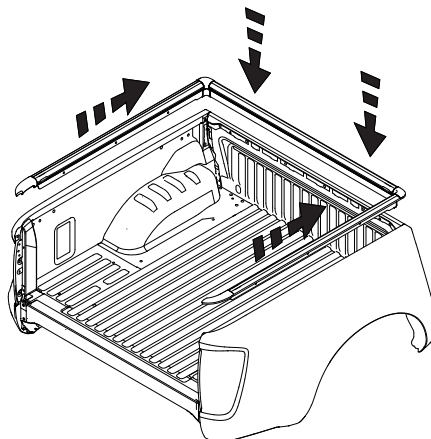
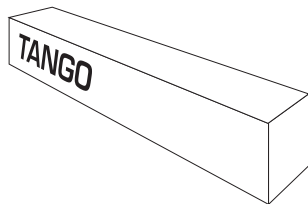

See Fitting kit K421 to fit, supplied in **TANGO** box.

16

Fitting Kit Number	Manufacturer	Model Type	Year	Stockist	Cab Size	Product	Revision	Date	Page
K420	Toyota	Hilux	2015	General Use	DC	SLT	1	18/12/15	4 of 11

After Paint process is complete continue with Step 17

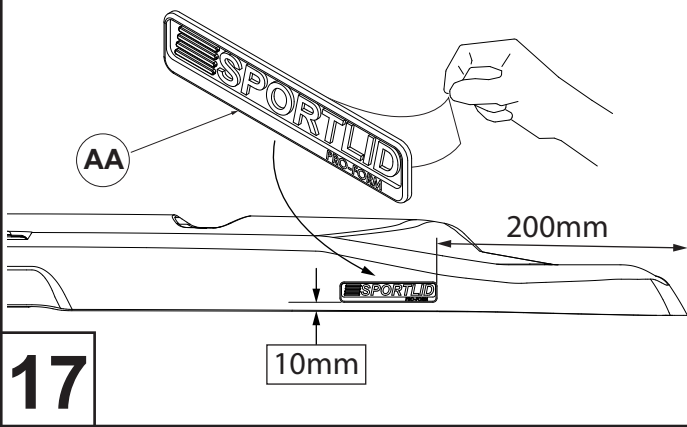

17

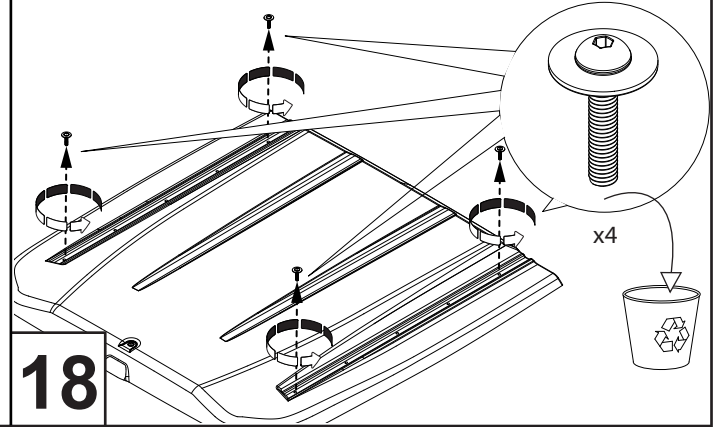

18

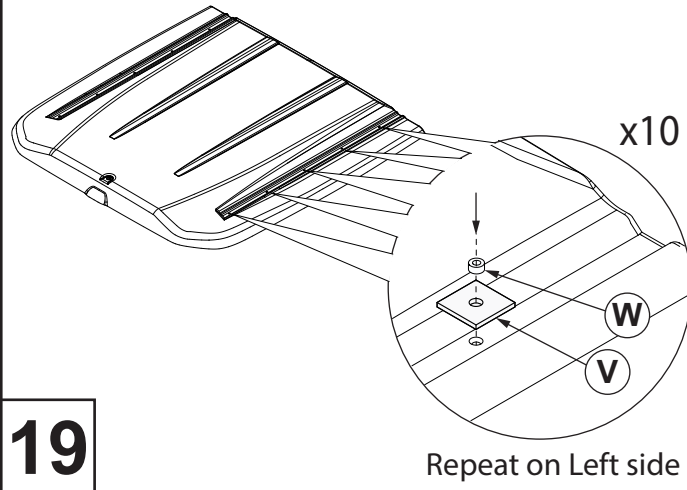

19

Repeat on Left side

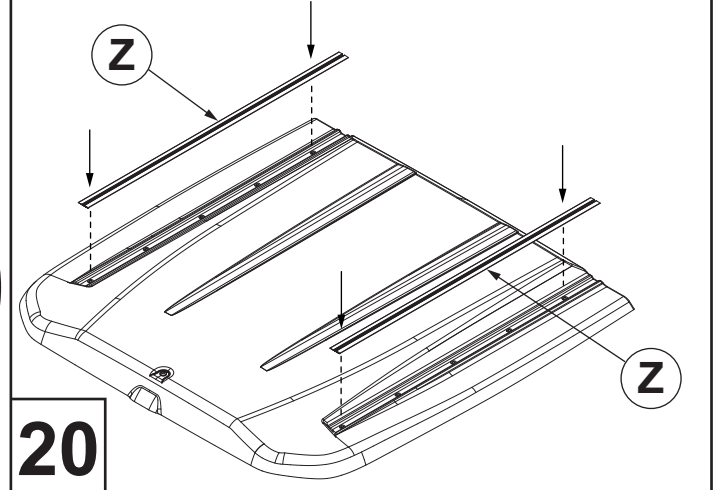

20

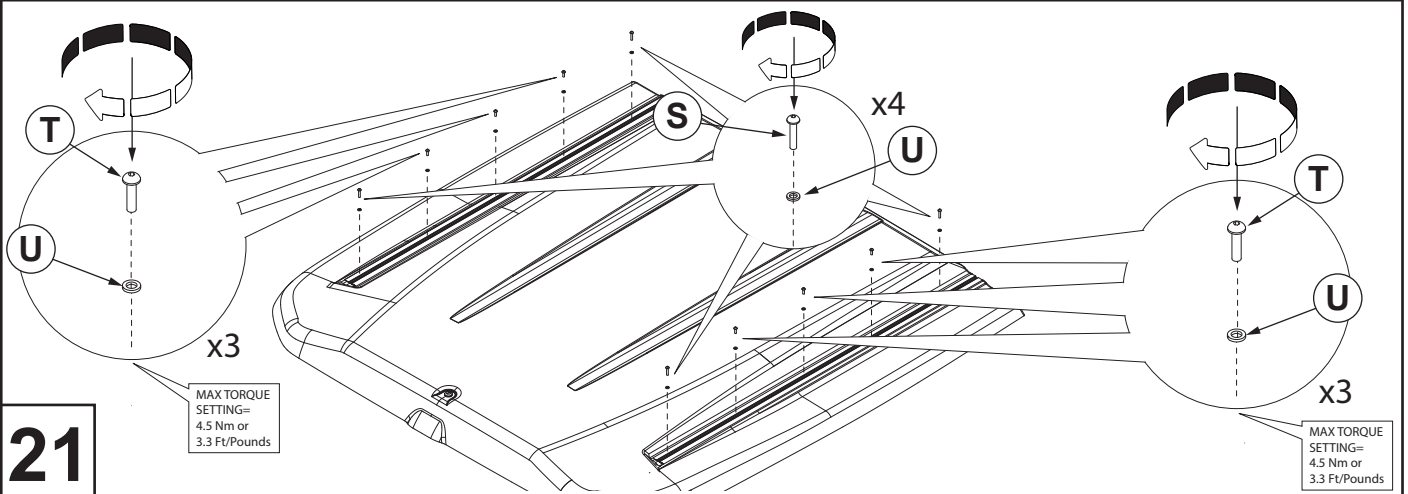

21

MAX TORQUE
SETTING=
4.5 Nm or
3.3 Ft/Pounds

MAX TORQUE
SETTING=
4.5 Nm or
3.3 Ft/Pounds

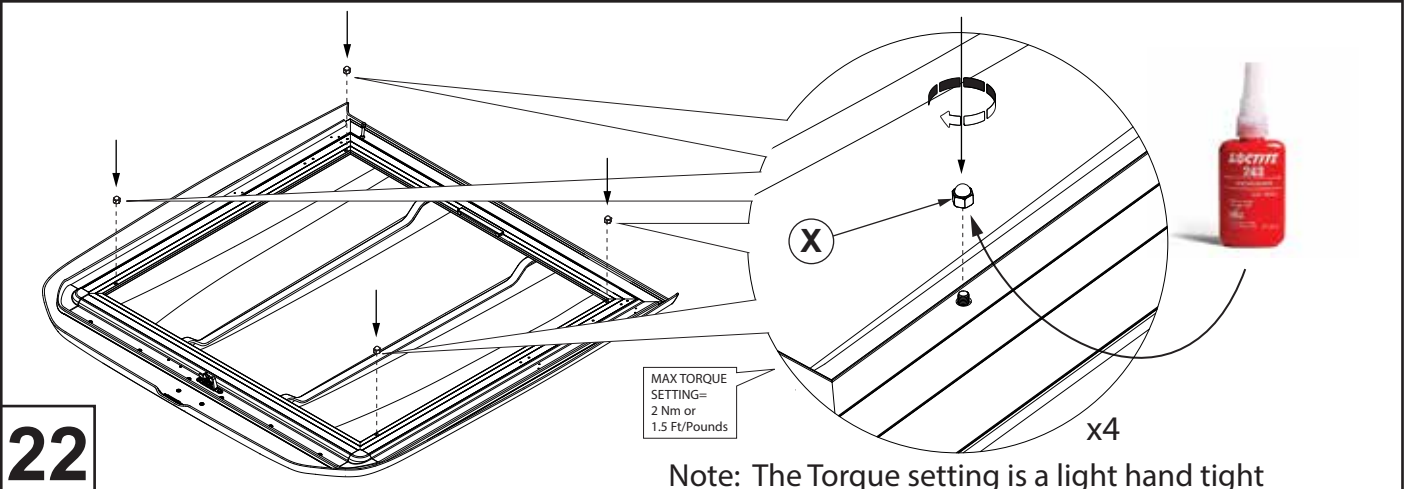

22

MAX TORQUE
SETTING=
2 Nm or
1.5 Ft/Pounds

Note: The Torque setting is a light hand tight

Fitting Kit Number	Manufacturer	Model Type	Year	Stockist	Cab Size	Product	Revision	Date	Page
K420	Toyota	Hilux	2015	General Use	DC	SLT	1	18/12/15	5 of 11

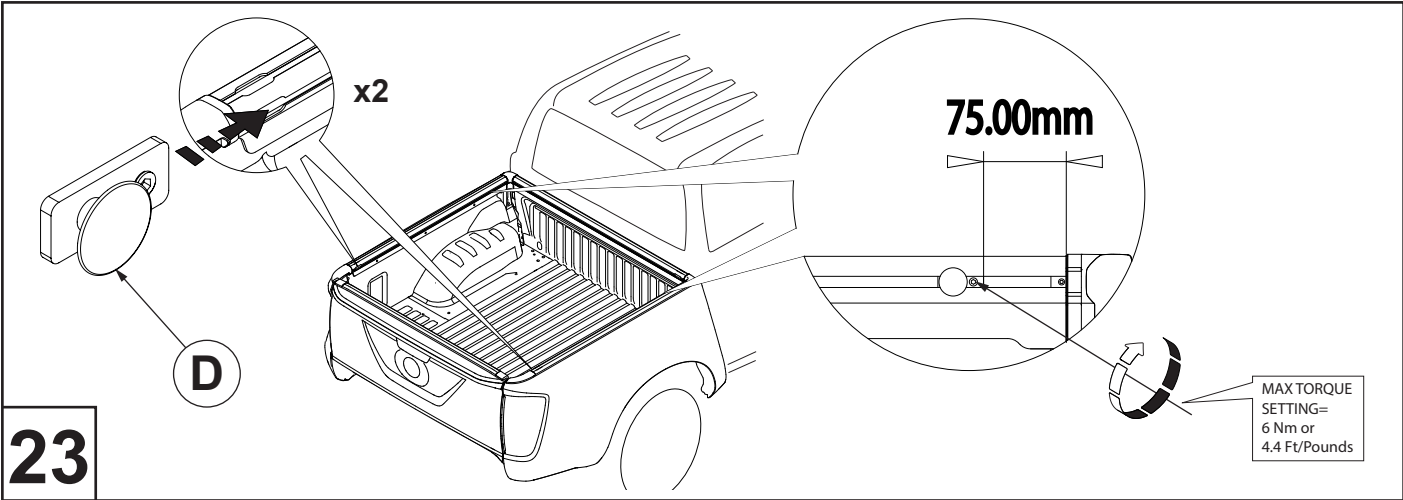

23

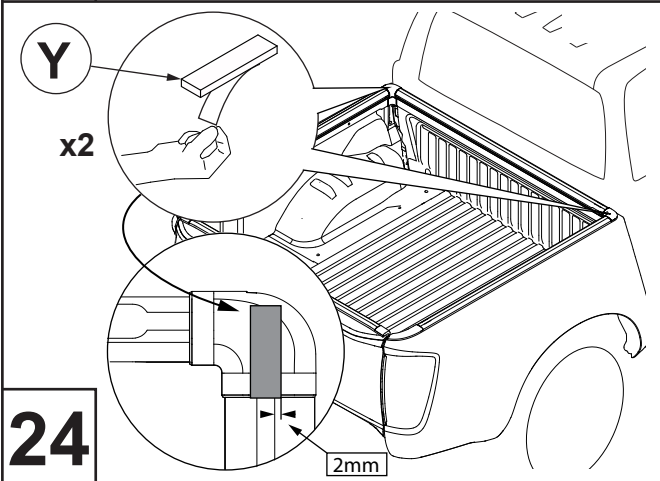

24

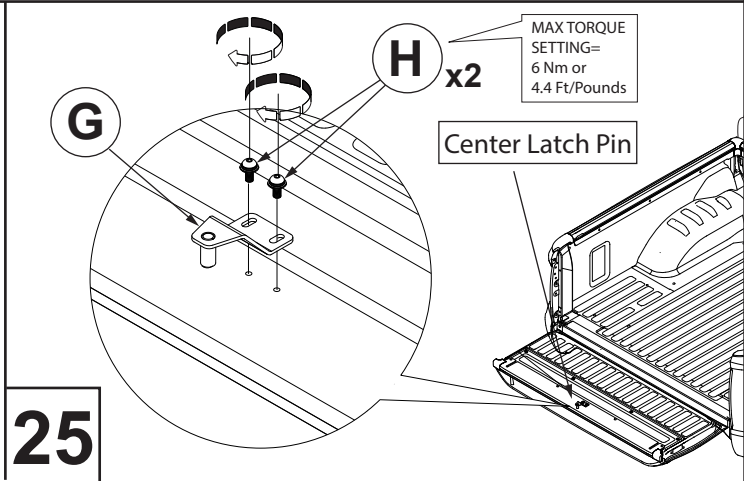

25

FITTING PROFORM SPORTBAR

SEE STEPS 26 TO 31

- **IMPORTANT** to take care and drill correct pictured holes

- Skip to STEP 62 when no **SPORTBAR** is being fitted.
- Skip to STEP 53 when Toyota OE Sportbar is being fitted.
- See fitting kit K313 to assemble **SPORTBAR**, follow assembly instructions till step 3 then refer to below steps 47 to 52.

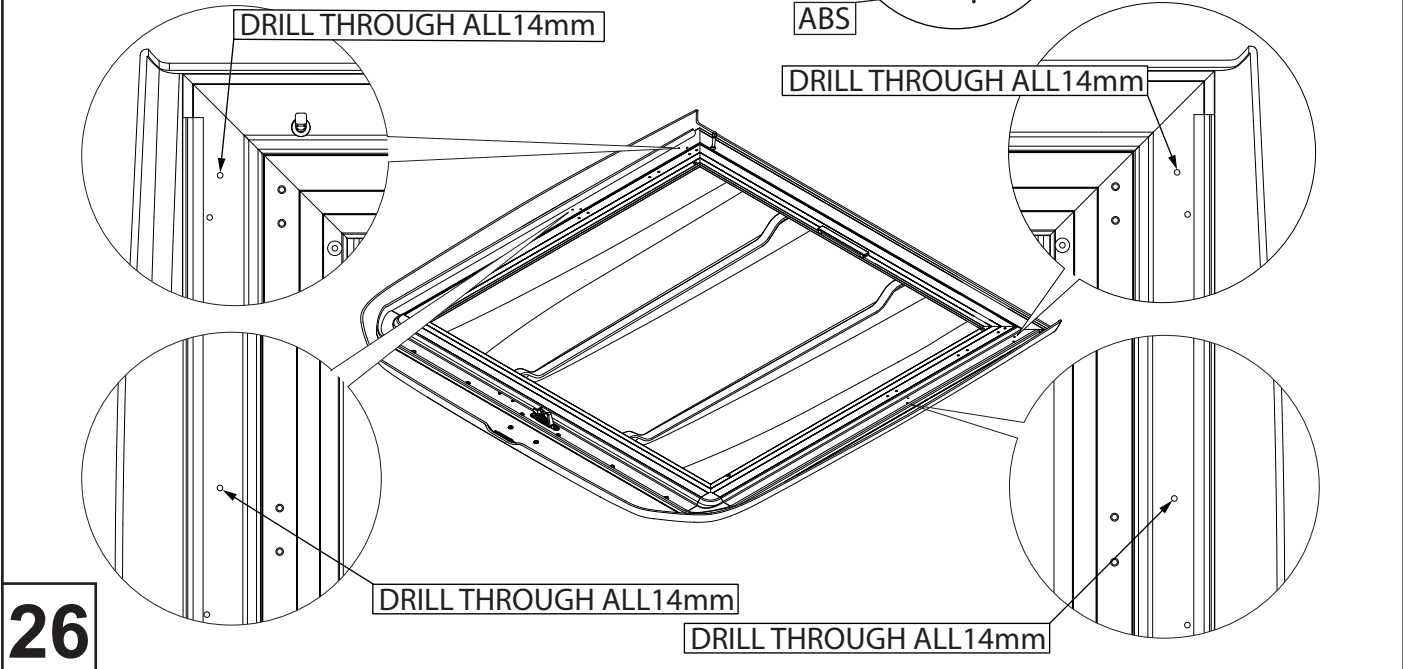

26

Fitting Kit Number	Manufacturer	Model Type	Year	Stockist	Cab Size	Product	Revision	Date	Page
K420	Toyota	Hilux	2015	General Use	DC	SLT	1	18/12/15	6 of 11

Refer to fitting kit K313 for parts. ◇

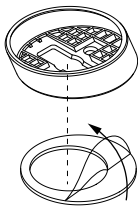

Remove Adhesive Cover

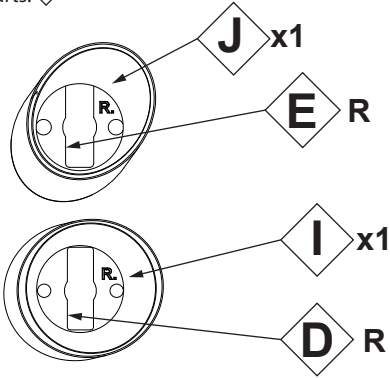

Position seals central with holes and slots exposed.
REPEAT FOR LEFT SIDE.

27

Refer to fitting kit K313 for parts. ◇

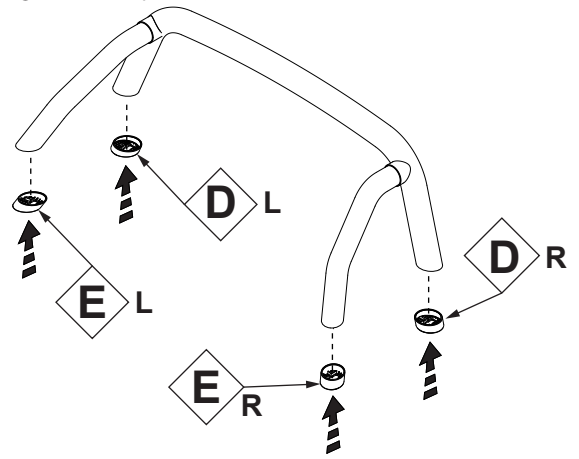

28

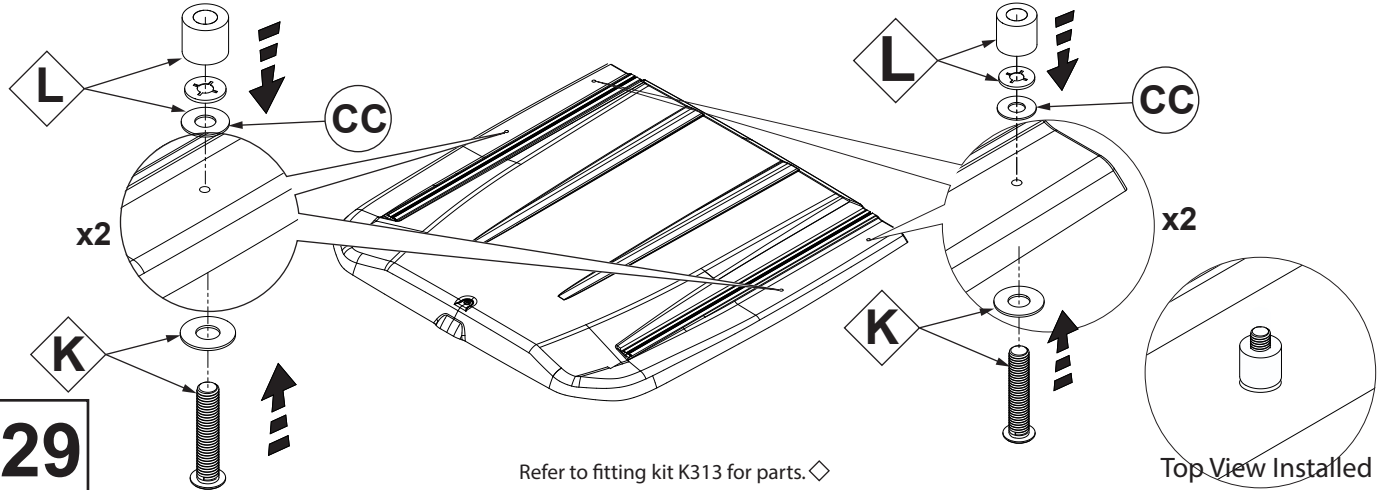

29

Refer to fitting kit K313 for parts. ◇

Top View Installed

Loosely bolt **SPORTBAR** to the **SPORTLID**.

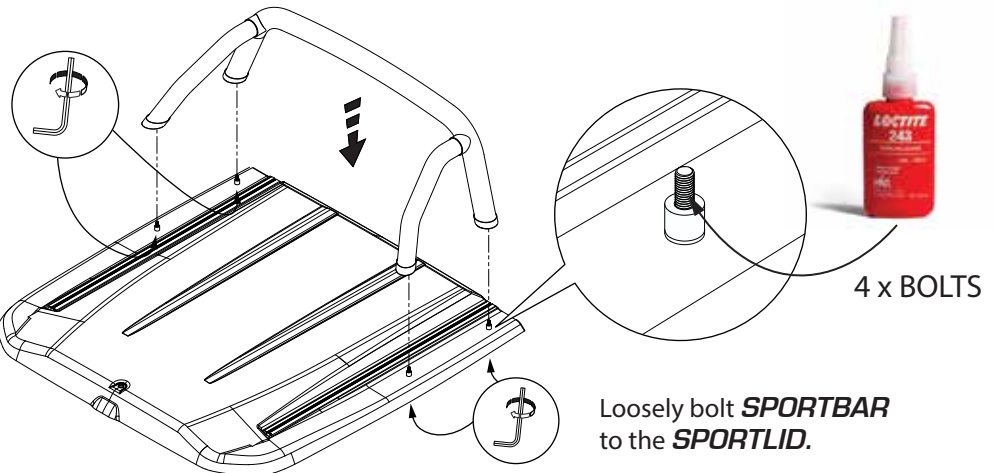

30

Loosely bolt **SPORTBAR** to the **SPORTLID**.

4 x BOLTS

MAX TORQUE SETTING=
8 Nm or
5.9 Ft/Pounds

Fully tighten 4 bolts on **SPORTBAR**

MAX TORQUE SETTING=
8 Nm or
5.9 Ft/Pounds

31

Fitting Kit Number	Manufacturer	Model Type	Year	Stockist	Cab Size	Product	Revision	Date	Page
K420	Toyota	Hilux	2015	General Use	DC	SLT	1	18/12/15	7 of 11

FITTING OE TOYOTA HILUX SPORTBAR

SEE STEPS 32 TO 36

- IMPORTANT to take care and drill correct holes.

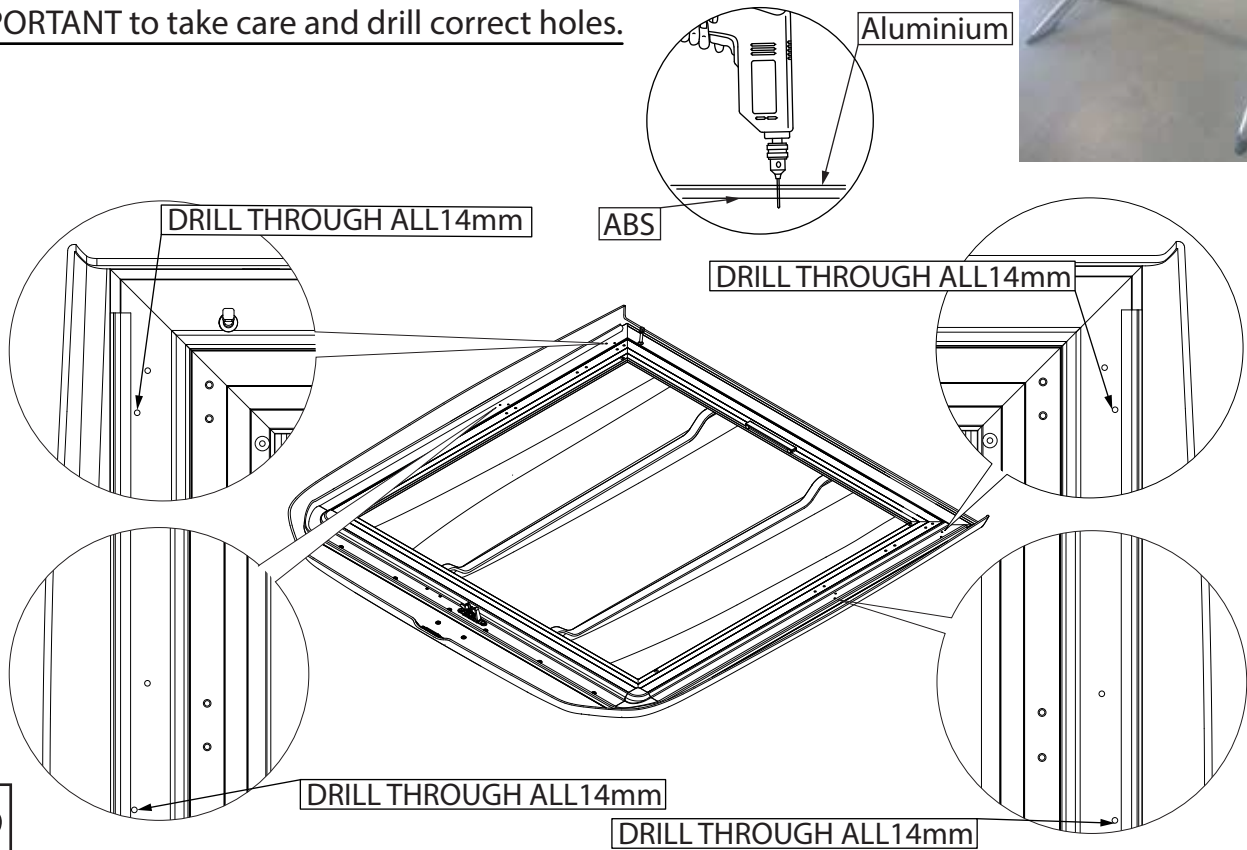

32

Detach OE Sportbar from vehicle.

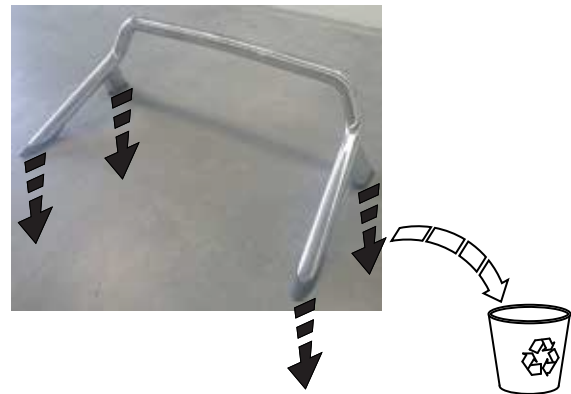

33

34

Remove and discard brackets and hardware

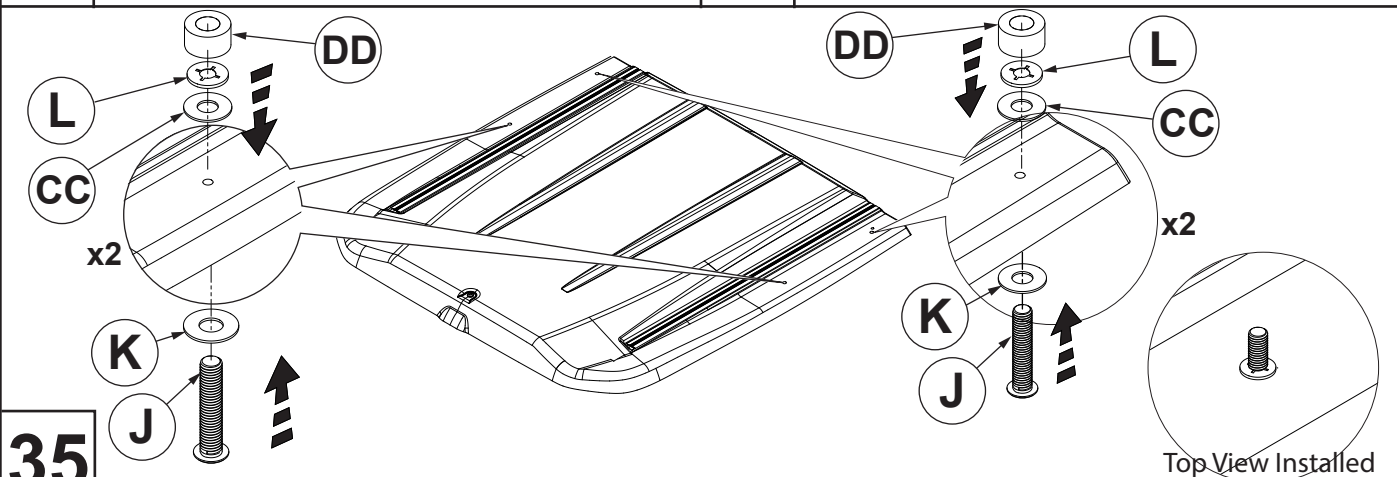

35

Top View Installed

Fitting Kit Number	Manufacturer	Model Type	Year	Stockist	Cab Size	Product	Revision	Date	Page
K420	Toyota	Hilux	2015	General Use	DC	SLT	1	18/12/15	8 of 11

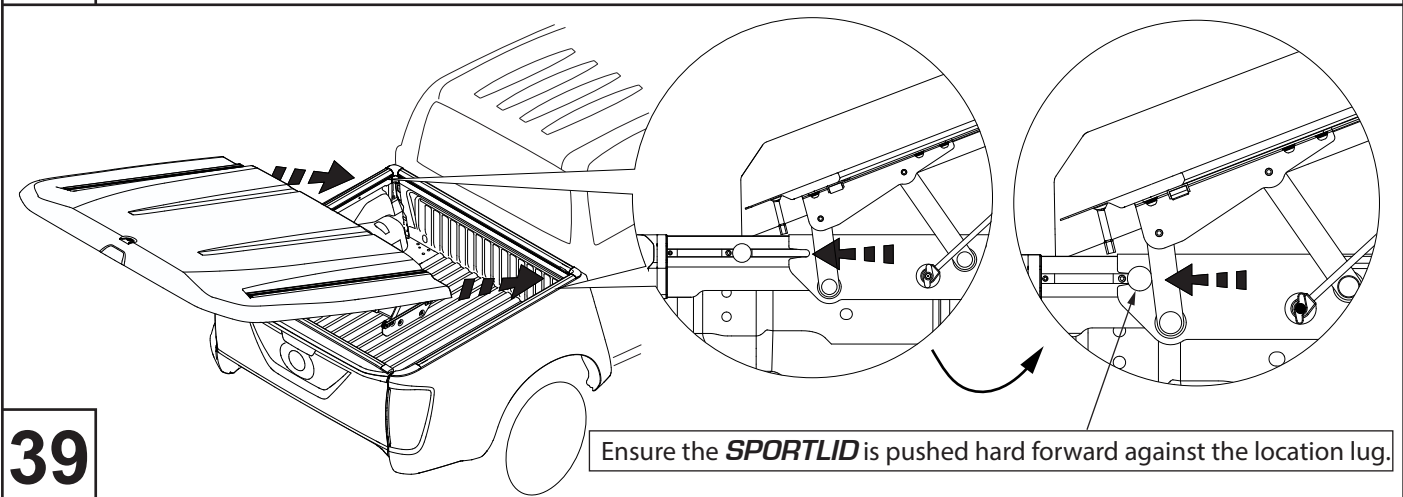
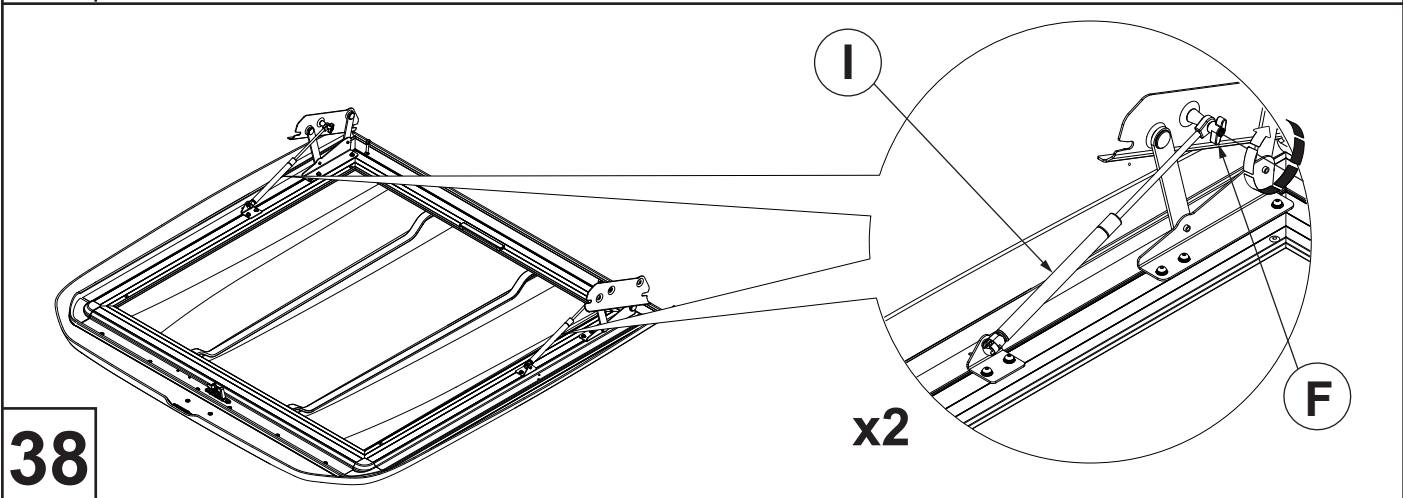
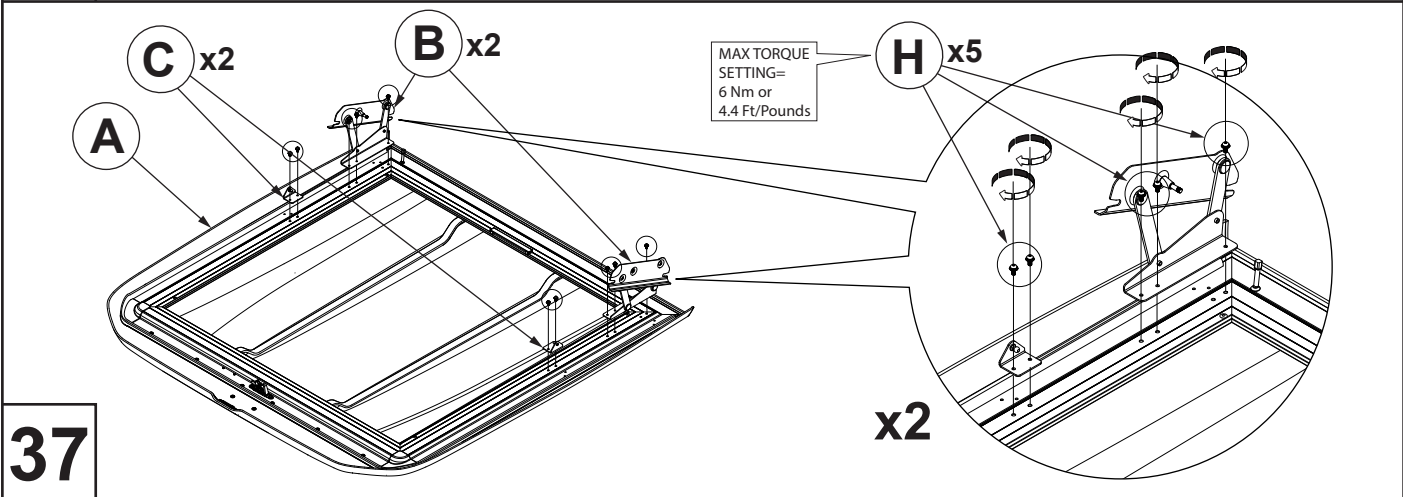
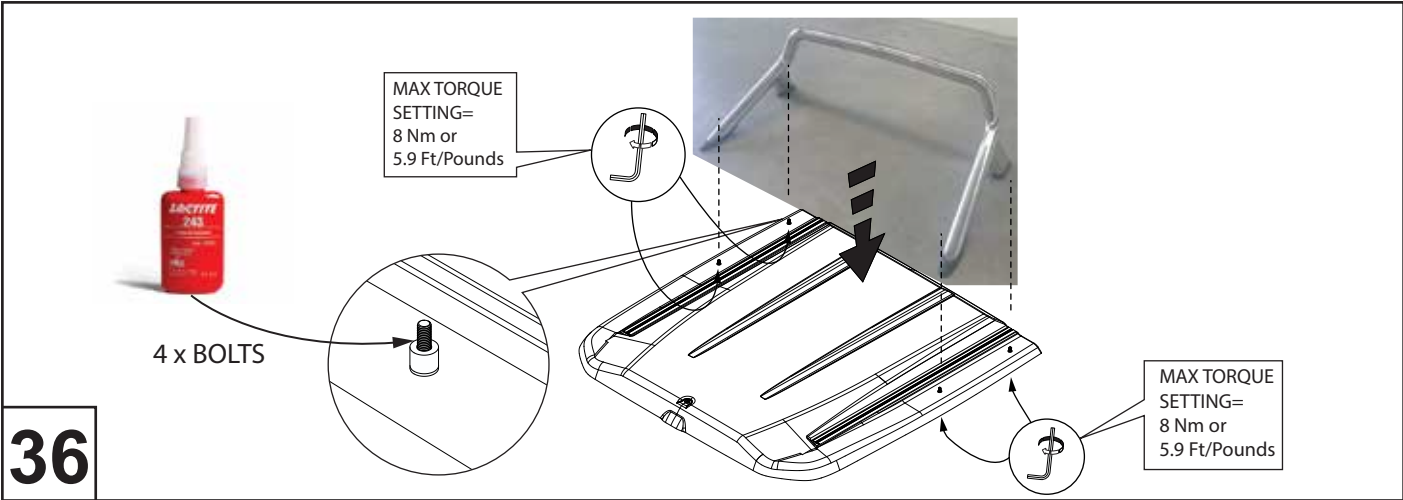

Fitting Kit Number	Manufacturer	Model Type	Year	Stockist	Cab Size	Product	Revision	Date	Page
K420	Toyota	Hilux	2015	General Use	DC	SLT	1	18/12/15	9 of 11

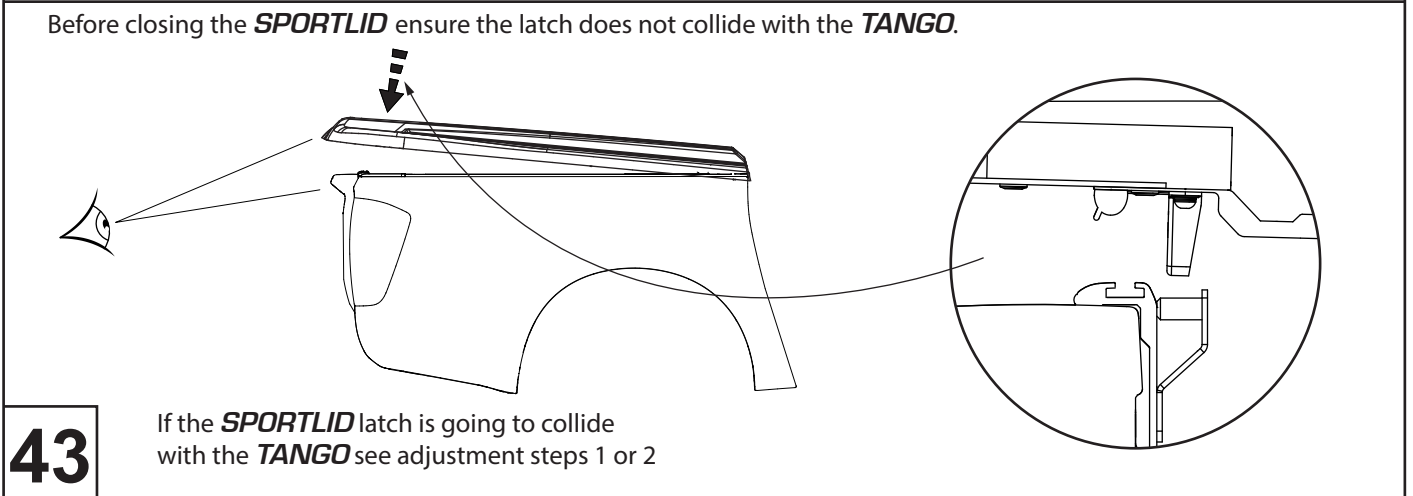
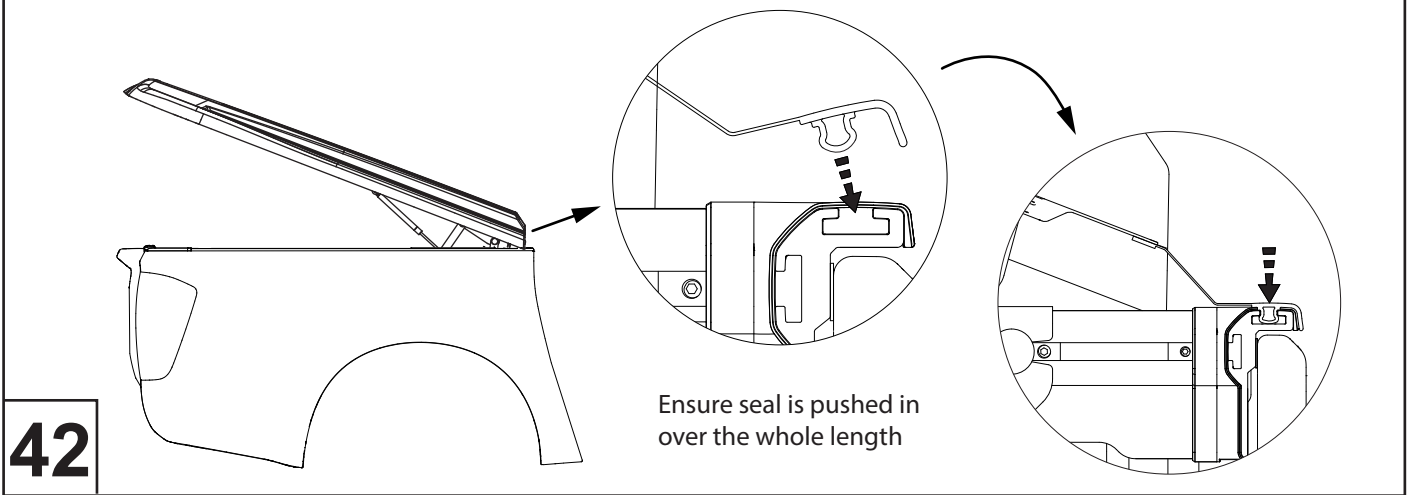
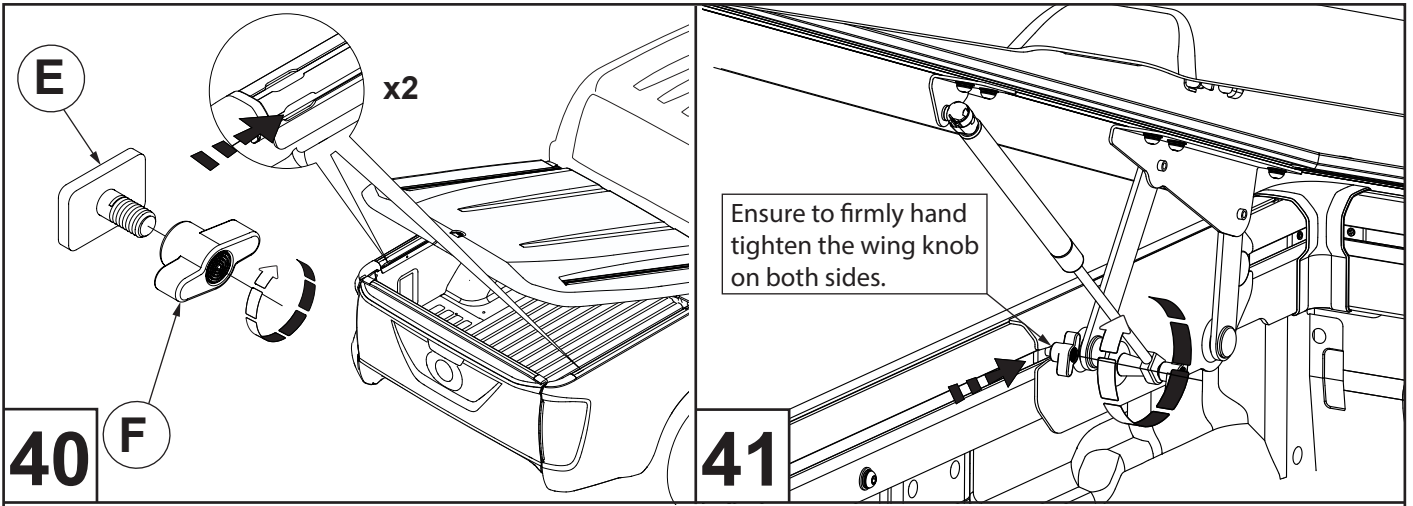

Fitting Kit Number	Manufacturer	Model Type	Year	Stockist	Cab Size	Product	Revision	Date	Page
K420	Toyota	Hilux	2015	General Use	DC	SLT	1	18/12/15	10 of 11

SPORTLID ADJUSTMENT SECTION

ADJUST BACKWARD AND FORWARD

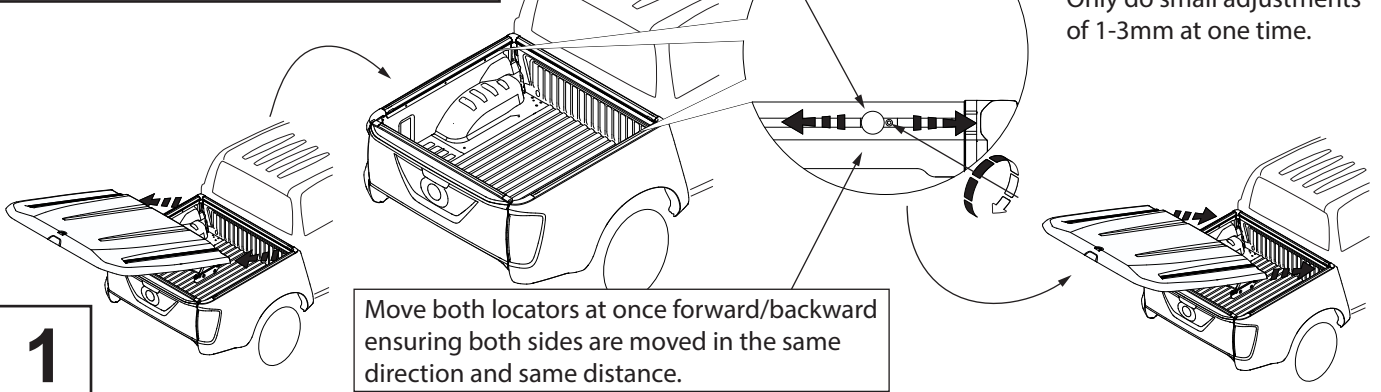

1

Move both locators at once forward/backward ensuring both sides are moved in the same direction and same distance.

LATCH ADJUSTMENT

Only use this adjustment if step 1 did not solve the problem.

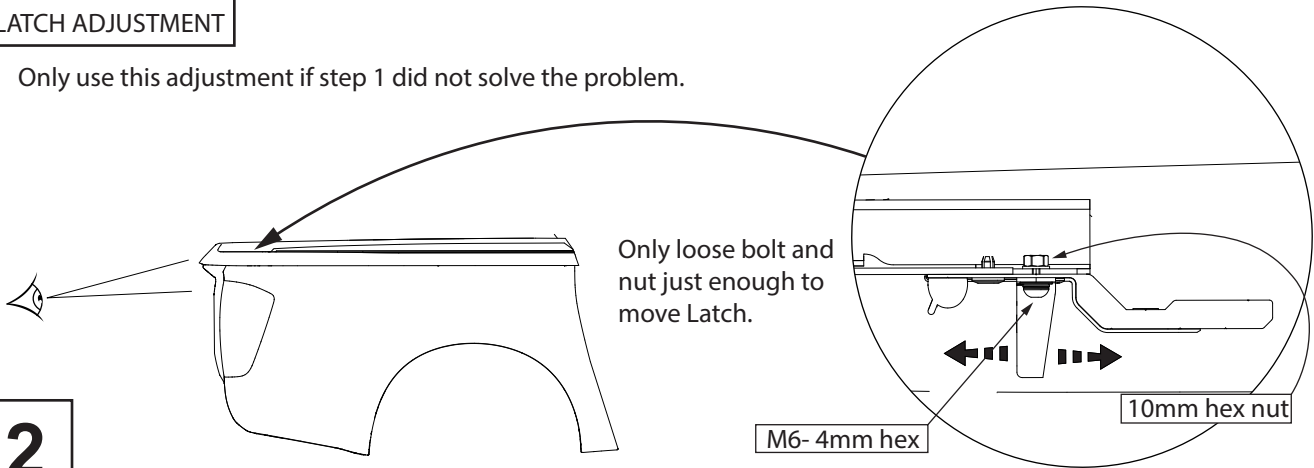

2

LATCHING/CLOSING ADJUSTMENT

To adjust **SPORTLID** latching, move latch pin up or down.

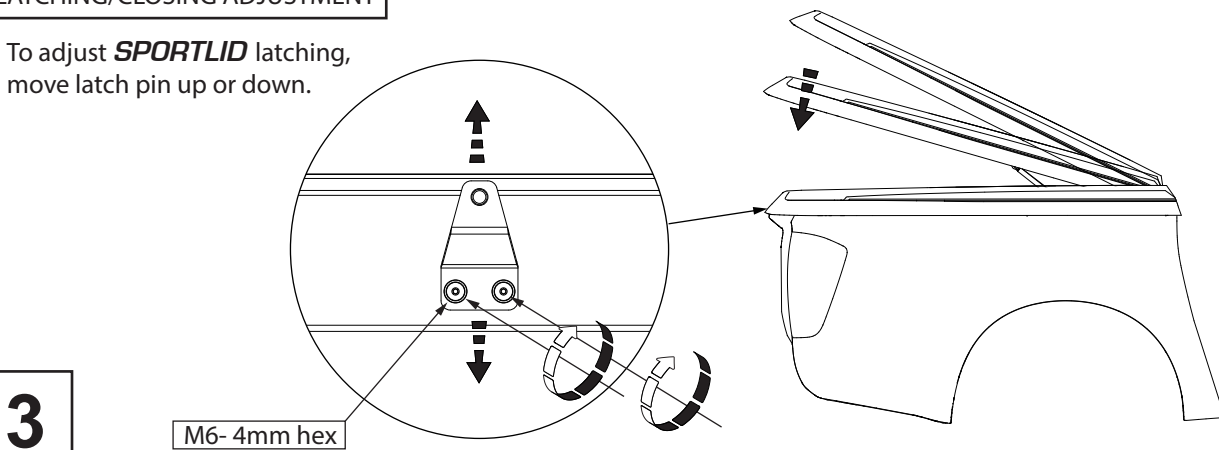

3

GAP ADJUSTMENT

Move **SPORTLID** locators individually back and forward 1-3mm to adjust the size of the gaps around the rear corners.

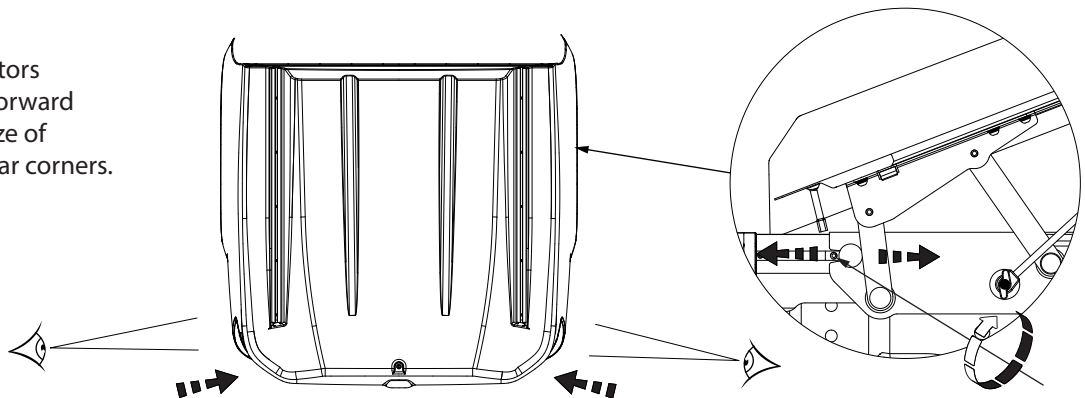

4

Fitting Kit Number	Manufacturer	Model Type	Year	Stockist	Cab Size	Product	Revision	Date	Page
K420	Toyota	Hilux	2015	General Use	DC	SLT	1	18/12/15	11 of 11