

FITTING INSTRUCTIONS

WARNING:

Before you begin installation, read all instructions thoroughly.
Proper tools will improve the quality of installation and reduce the time required.

- This product should be installed as demonstrated in the *Product «Fitting Instructions»*;
- The specified parts, will only fit the models specified by **AFN**;
- Do not modify any component of the product;
- It is recommended that this product is installed by specialized and trained personnel;
- AFN doesn't take responsibility for changes made in the vehicle by its manufacturer;
- Work safely and use specialized tools at all times;
- **Always use protective gear.**



Size	Torque Nm	Torque lbft
M6	9 Nm	7 lbft
M8	22 Nm	16 lbft
M10	44 Nm	32 lbft
M12	77 Nm	57 lbft

Mouting Time

- 1 hour
- 2 persons (recommended)

Tools Required

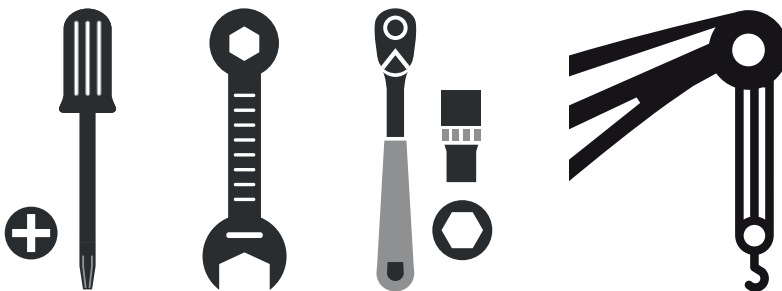

- Screwdriver star head
- Wrench
- Ratchet wrench
- Crane

STEP 1 - FITTING AFN REAR BUMPER IN THE VEHICLE

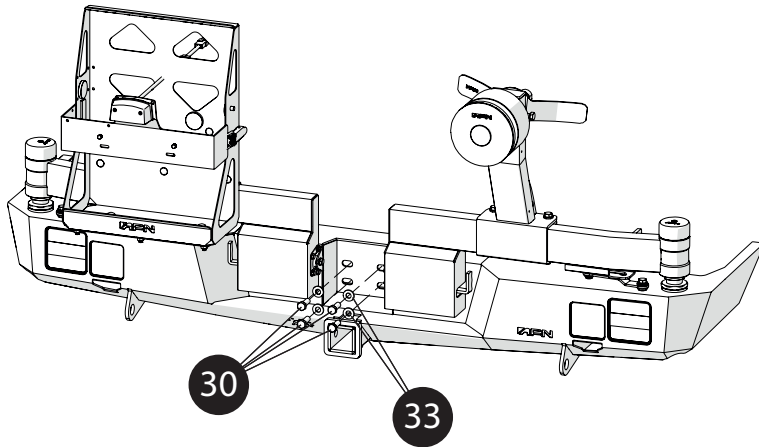

NUMBER	REF	QUANTITY
30	45001587	4x
33	45001253	4x

The AFN Rear Bumper is very easy to fit.

Start by fitting the center, using 4x Bolts M12x35x1.25(**30**) with 4x Washers M12(**33**).

Do not tighten yet.

STEP 1.1 - FITTING AFN REAR BUMPER IN THE VEHICLE

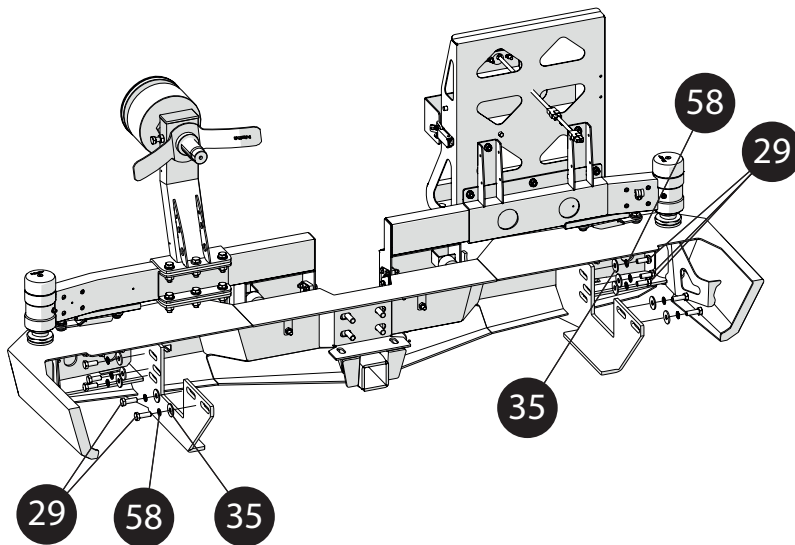

NUMBER	REF	QUANTITY
28	45001589	6x
29	45001588	4x
35	45001251	10x
58	45000222	10x

Once that is done, fit the sides of the Rear Bumper.

Use 6x Bolts M10x25x1.25(**28**) with 6x Pressure Washers M10(**58**) and 6x Washers M10(**35**). Also use 4x Bolts M10x30x1.25(**29**) with 4x Pressure Washers M10(**58**) and 4x Washers M10(**35**).

Once everything is in place,
Give the Final torque.

STEP 2 - HITCH TRAILER

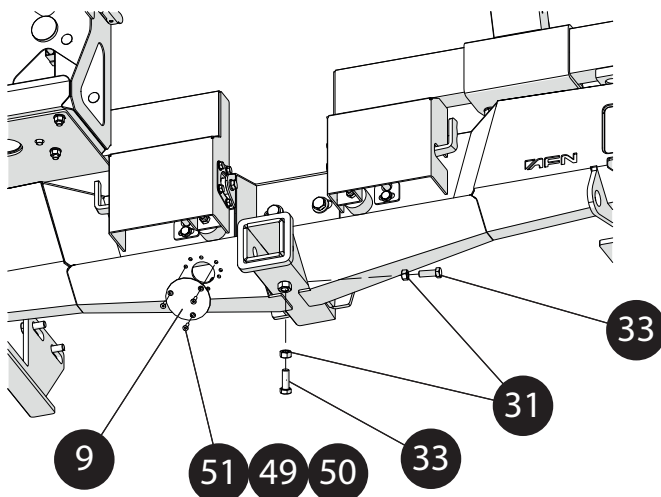

NUMBER	REF	QUANTITY
9	46009068	1x
31	46003288	1x
33	45001607	8x
49	45001042	3x
50	45000992	3x
51	45000982	3x

Then, fit the Cover for Cable Hitch Plug(**9**) using 3x Bolts M4x16(**51**) with 3x Washers M4(**49**) and 3x Nylock Nuts M4(**50**).

Finally, fit the bolts that secure the hitch trailer in the hitch hook.

Use 2x Bolts M12x35(**33**) and 2x Nuts M10(**31**).

Once everything is in place,
Give the Final torque.